

**SVC-R**

**720P AHD Vehicle Camera**



## **Safety Advice**



Please unpack the box carefully and identify that all the parts are present.



Make sure you use the recommended power input. Damage caused to the camera by incorrect voltage is not covered by the warranty.



Do not attempt to open the casing to access the camera. Damage caused to the camera by tampering with the camera casing is not covered by the warranty.

## **What's in the box**

- Camera
- Small screw tool



## Introduction

The SVC-R is a 720P AHD Camera.

## Adjusting the Camera

To adjust the angle of the dome camera, use the screw tool provided and unscrew the screws located on the sides of the camera.

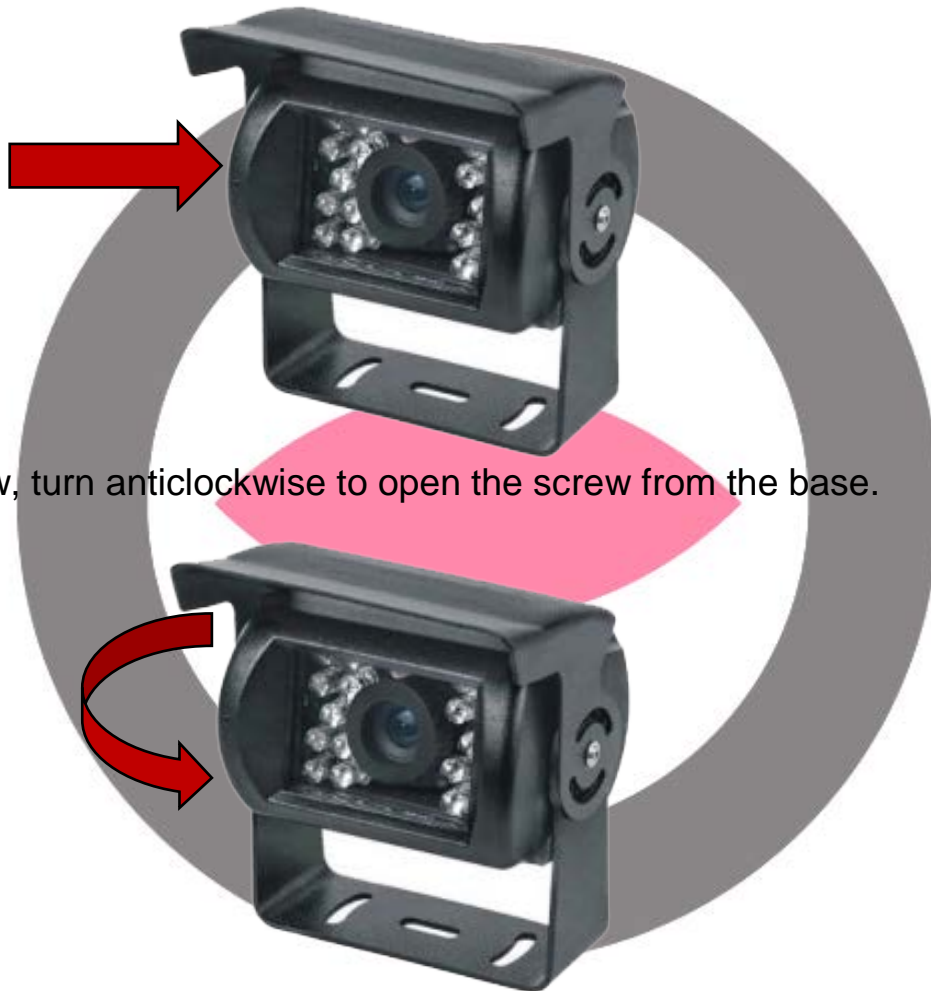

To unscrew, turn anticlockwise to open the screw from the base.

Then adjust the camera by moving the lower bracket.



# Specifications

## SVC-R

|                       |   |
|-----------------------|---|
| Video System          | PAL   |
| Pick Up Element       | 1/4" CMOS Image Sensor  |
| Image Signal Process  | Digital Signal Processing System                                  |
| Lens / Viewing Angle  | 3.6mm 120 degree  |
| Number Of Pixel       | 1280x720  |
| Effective Pixels      | Approximately 3 Megapixel   |
| Resolution            | AHD 720P  |
| Power Supply          | DC 12 ± 1A, Aviator connector to MDVR                             |
| Power Consumption     | 80mA  |
| Scanning System       | 2:1 Interlace   |
| Sensitivity           | 0.01 Lux (IR 10m)   |
| S/N Ratio             | Max 62 dB   |
| Auto Gain Control     | Auto  |
| Mirroring             | Optional (BV)   |
| White Balance         | Auto  |
| Electronic Shutter    | Auto: 1/50 S to 1/100,000 S (Pal)                                 |
| Output                | 1 Vp-p Composite Video Output, 75 OHMS, Aviator connector to MDVR |
| Operating Temperature | -10°C ~ +60°C   |
| Dimensions (HxWxD)    | 65 x 77 x 92 mm   |
| Weight                | 280g  |
| IP Rating             | IP69  |

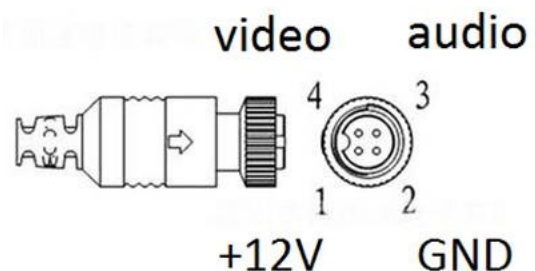



SmartWitness UK

5 The Pavilion, Amber Close,  
Tamworth, B77 4RP

+44(0) 1483 397005

[sales@smartwitness.com](mailto:sales@smartwitness.com)

SmartWitness USA

1016 Lunt Avenue, Schaumburg,  
IL 60193, USA

+1 (312) 981-8774

[sales.usa@smartwitness.com](mailto:sales.usa@smartwitness.com)

SmartWitness Canada

Metrotower 2, 2600-4720  
Kingsway Burnaby, BC V5H  
4N2, Canada

+1 (778) 994-6670

[sales.can@smartwitness.com](mailto:sales.can@smartwitness.com)