



CP-S



CP-R



CP-V



CP-VA



CP-P

# CP Series

Vehicle Cameras

# User Manual

## Index

<b>CP-S</b> 960H Analog Vehicle Camera .....	Page 3
<b>CP-R</b> 960H Analog Vehicle Camera .....	Page 7
<b>CP-V</b> 960H Analog Vehicle Camera .....	Page 9
<b>CP-VA</b> 960H Analog Vehicle Camera with Audio.....	Page 12
<b>CP-P</b> 960H Analog Vehicle Camera.....	Page 15

---

## Safety Advice



Please unpack the box carefully and identify that all the parts are present.



Make sure you use the recommended power input. Damage caused to the camera by incorrect voltage is not covered by the warranty.



Do not attempt to open the casing to access the camera. Damage caused to the camera by tampering with the camera casing is not covered by the warranty.

## What's in the box

*(applies to all models)*

- Camera
  - Small Screw Tool
-

## Introduction

The CP-S is a 960H Analog Camera.

It features a 2.88mm lens and has a viewing angle between 110-120°.

## Adjusting the Camera

To adjust the angle of the camera, use the screw tool provided and unscrew the screws located on the sides of the camera. There are 3 in total.



To unscrew, turn anticlockwise to open the screw from the base.



Then adjust the camera, remove the protective bracket holding it in place.



## Adjusting the Camera Continued

Then adjust the camera manually with your hand to your preferred position.



After you have completed your adjustment, replace the protective bracket



Then close the casing of the camera and screw back the screws.



## Mounting the camera

To mount the camera, remove the screws from all sides



Drill a hole in the centre of the camera and screw it into your desired location.



Replace the camera and screw in the screws.



## Specification

Video System  
Pick Up Element  
Image Signal Process  
Lens / Viewing Angle  
Number Of Pixel  
Effective Pixels  
Resolution  
Audio  
Power Supply  
Power Consumption  
Scanning System  
Sensitivity  
S/N Ratio  
Auto Gain Control  
Mirroring  
White Balance  
Electronic Shutter  
Output  
  
Operating Temperature  
Dimensions (HxWxD)  
Weight  
IP Rating

## CP-S

PAL  
Colour Sony 1/3" CCD Image Sensor  
Digital Signal Processing System  
2.8mm - 96°  
960 x 576  
960 (H)× 576 (V)  
Analog 700TVL  
No  
DC 12 ± 1A, Aviator connector to MDVR  
5 Watts  
2:1 Interlace  
0.01 Lux (IR 10m)  
Max 62 dB  
Auto  
Yes  
Auto  
Auto: 1/50 S to 1/100,000 S (Pal)  
1 Vp-p Composite Video Output,  
75 OHMS, Aviator connector to MDVR  
-10°C ~ +60°C  
89 x 77 x 63mm  
215g  
IP69K

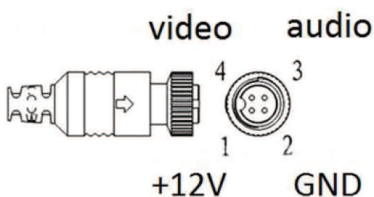

## Introduction

The CP-R is a 960H Analog Rear view Mirrored camera.

## Adjusting the Camera

To adjust the angle of the dome camera, use the screw tool provided and unscrew the screws located on the sides of the camera.

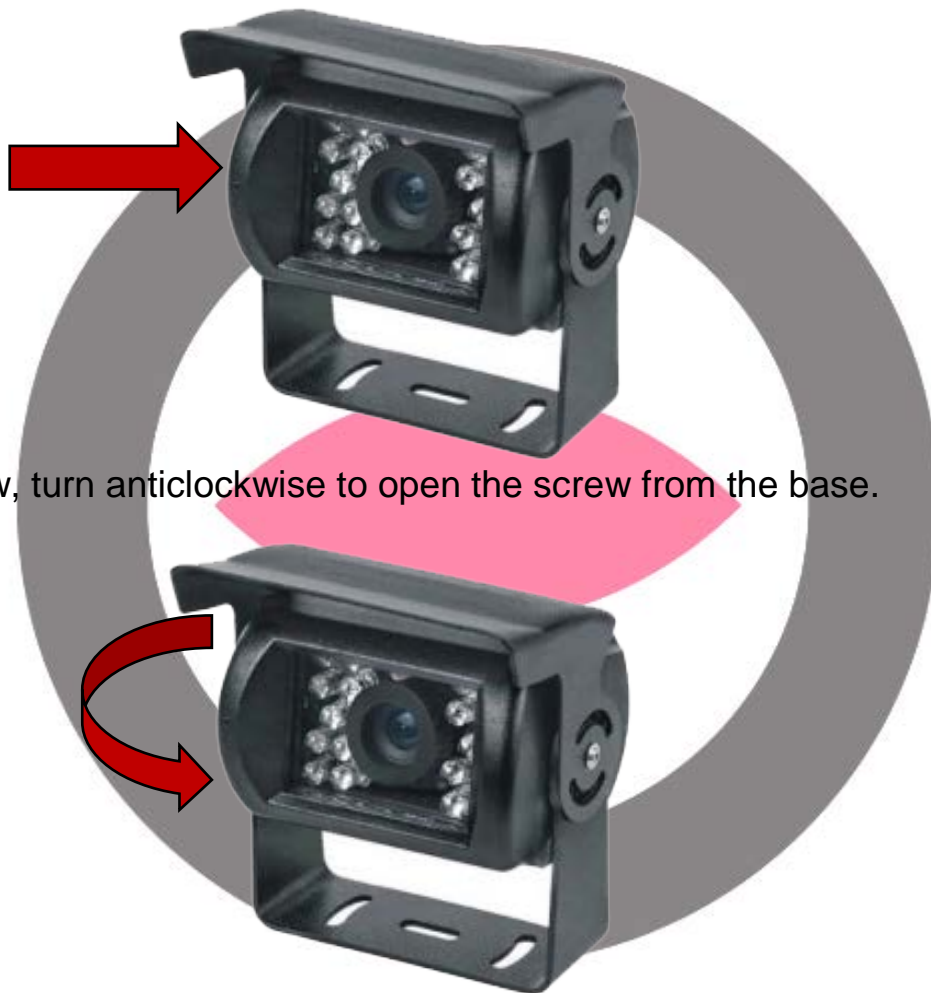

To unscrew, turn anticlockwise to open the screw from the base.

Then adjust the camera by moving the lower bracket.



## Specification

## CP-R

Video System	PAL
Pick Up Element	Colour Sony 1/3" CCD Image Sensor
Image Signal Process	Digital Signal Processing System
Lens / Viewing Angle	2.8mm - 96°
Number Of Pixel	960 x 576
Effective Pixels	960 (H)× 576 (V)
Resolution	Analog 700TVL
Audio	No
Power Supply	DC 12 ± 1A, Aviator connector to MDVR
Power Consumption	5 Watts
Scanning System	2:1 Interlace
Sensitivity	0.01 Lux (IR 10m)
S/N Ratio	Max 62 dB
Auto Gain Control	Auto
Mirroring	Yes
White Balance	Auto
Electronic Shutter	Auto: 1/50 S to 1/100,000 S (Pal)
Output	1 Vp-p Composite Video Output, 75 OHMS, Aviator connector to MDVR
Operating Temperature	-10°C ~ +60°C
Dimensions (HxWxD)	89 x 77 x 70mm
Weight	285g
IP Rating	IP69K

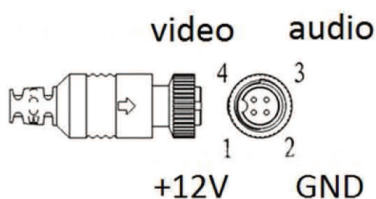



## **Introduction**

The CP-V is a 960H Analog Dome Camera.

It features a 2.88mm lens and has a viewing angle between 90-100°.

## **Adjusting the Camera**

To adjust the angle of the dome camera, use the screw tool provided and unscrew the screws located on the sides of the camera. There are 3 in total.



To unscrew, turn anticlockwise to open the screw from the base.



Then adjust the camera by turning it to the required position then replace the bottom bracket.

## Mounting the Camera Continued

Get the correct drill bit for the size of the holes which you need to drill.



After drilling, feed through the camera wires into the base, as shown above. Then screw back the remaining screws.



## Specification

## CP-V

Video System	PAL
Pick Up Element	Colour Sony 1/3" CCD Image Sensor
Image Signal Process	Digital Signal Processing System
Lens / Viewing Angle	2.8mm - 96°
Number Of Pixel	960 x 576
Effective Pixels	960 (H)× 576 (V)
Resolution	Analog 700TVL
Audio	No
Power Supply	DC 12 ± 1A, Aviator connector to MDVR
Power Consumption	5 Watts
Scanning System	2:1 Interlace
Sensitivity	0.01 Lux (IR 10m)
S/N Ratio	Max 62 dB
Auto Gain Control	Auto
Mirroring	No
White Balance	Auto
Electronic Shutter	Auto: 1/50 S to 1/100,000 S (Pal)
Output	1 Vp-p Composite Video Output, 75 OHMS, Aviator connector to MDVR
Operating Temperature	-10°C ~ +60°C
Dimensions (HxWxD)	82 x 86 x 86mm
Weight	215g
IP Rating	IP66

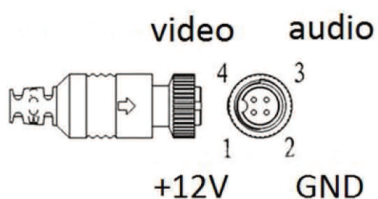

## **Introduction**

The CP-VA is a Internal only 960H Analog Dome Camera with built in audio  
It features a 2.88mm lens and has a viewing angle between 90-100°.

## **Adjusting the Camera**

To adjust the angle of the dome camera, use the screw tool provided and unscrew the screws located on the sides of the camera. There are 3 in total.



To unscrew, turn anticlockwise to open the screw from the base.



Then adjust the camera by turning it to the required position then replace the bottom bracket.

## Mounting the Camera Continued

Get the correct drill bit for the size of the holes which you need to drill.



After drilling, feed through the camera wires into the base, as shown above. Then screw back the remaining screws.



## Specification

## CP-VA

Video System	PAL
Pick Up Element	Colour Sony 1/3" CCD Image Sensor
Image Signal Process	Digital Signal Processing System
Lens / Viewing Angle	2.8mm - 96°
Number Of Pixel	960 x 576
Effective Pixels	960 (H)× 576 (V)
Resolution	Analog 700TVL
Audio	Built-in
Power Supply	DC 12 ± 1A, Aviator connector to MDVR
Power Consumption	5 Watts
Scanning System	2:1 Interlace
Sensitivity	0.01 Lux (IR 10m)
S/N Ratio	Max 62 dB
Auto Gain Control	Auto
Mirroring	No
White Balance	Auto
Electronic Shutter	Auto: 1/50 S to 1/100,000 S (Pal)
Output	1 Vp-p Composite Video Output, 75 OHMS, Aviator connector to MDVR
Operating Temperature	-10°C ~ +60°C
Dimensions (HxWxD)	50 x 69 x 69mm
Weight	310g
IP Rating	IP66

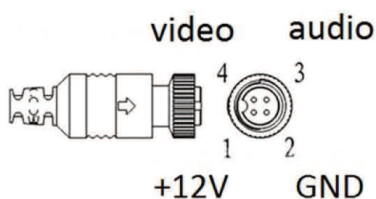

## Introduction

The CP-P is a 960H Analog Internal Dome Camera.

It features a 2.88mm lens and has a viewing angle between 90-100°.

## Adjusting the Camera

To adjust the angle of the dome camera, use the screw tool provided and unscrew the screws located on the sides of the camera. There are 3 in total.



To unscrew, turn anticlockwise to open the screw from the base.



Then adjust the camera, remove the protective bracket holding it in place.



## Adjusting the Camera Continued

Then adjust the camera manually with your hand to your preferred position.



After you have completed your adjustment, replace the protective bracket



Then close the casing of the camera and screw back the screws.





## Specification

Video System

Pick Up Element

Image Signal Process

Lens / Viewing Angle

Number Of Pixel

Effective Pixels

Resolution

Audio

Power Supply

Power Consumption

Scanning System

Sensitivity

S/N Ratio

Auto Gain Control

Mirroring

White Balance

Electronic Shutter

Output

Operating Temperature

Dimensions (HxWxD)

Weight

IP Rating

## CP-P

PAL

Colour Sony 1/3" CCD Image Sensor

Digital Signal Processing System

2.8mm - 96°

960 x 576

960 (H) × 576 (V)

Analog 700TVL

No

DC 12 ± 1A, Aviator connector to MDVR

5 Watts

2:1 Interlace

0.01 Lux (IR 10m)

Max 62 dB

Auto

No

Auto

Auto: 1/50 S to 1/100,000 S (Pal)

1 Vp-p Composite Video Output,

75 OHMS, Aviator connector to MDVR

-10°C ~ +60°C

63 x 118 x 118mm

270g

None

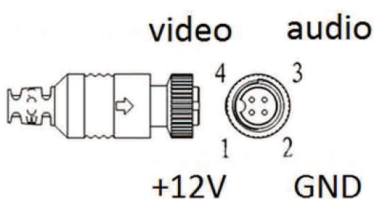



### SmartWitness UK

Unit 2 Valley point  
Beddington Farm  
Road, Croydon, Surrey,  
CR0 4WP  
+44(0) 1483 397005  
sales@smartwitness.com

### SmartWitness USA

1016 Lunt Avenue,  
Schaumburg, IL 60193, USA  
  
+1 (312) 981-8774  
sales.usa@smartwitness.com

### SmartWitness Canada

Metrotower 2, 2600-4720  
Kingsway Burnaby, BC V5H  
4N2, Canada  
  
+1 (778) 994-6670  
sales.can@smartwitness.com