



SmartWitness SVC1080-LCS



Installation Guide

v.1.2

WARNING: SmartWitness installations should be performed by a qualified individual or installation professional only. Working with a vehicle's power system can be dangerous to both you and your vehicle. This installation is intended only to be a guide since vehicle designs and power/input sources can vary significantly from vehicle to vehicle.

1. Overview:

The SVC1080-LCS is a 1080P Full HD accident camera for commercial vehicles. SVC1080-LCS features an integrated 3-Axis G-sensor, microphone, integrated GPS receiver, permanent power cable, and a tamper-resistant design. SDHC storage, up to 64GB. Mac and PC analysis software included.

SVC1080-LCS is the HD successor to the bestselling SVC100GPS, SmartWitness' flagship product which has sold over 200,000 units to date.

➤ Package Contents:



SVC1080-LCS Recorder with locking SD cover



Power Cable



Screw & Bracket lock (2ea)



3M Windshield Adhesive



Key for SD Locking Cover (2ea)



SD Card



Quick Start Guide

**PC software is located on the SD card in the "software" folder or can be downloaded online at support.smartwitness.com (Mac software also available online)*



➤ **Benefits:**

The SVC1080-LCS features a full HD (1080P), 170° lens to provide a comprehensive view of any incident. The LCS will record exactly what happened before, during and after an incident. It does this by recording the following information: drivers view of the road, vehicle location, impact force of accident, audio, and driving style such as the following: speed, acceleration, braking, and steering.

This evidence can protect a driver from many of the issues faced on the roads today: insurance fraud, staged accidents, false/exaggerated whiplash claims, conflicting reports of actual events, driving offence allegations such as: speeding, traffic signal violations, swerving, etc.

➤ **Features:**

Recording	Playback & Analysis
HD 170° wide angle lens.	Mac & PC software included.
Dual record mode (Continuous + Event).	Filter data search by time/date, event, vehicle speed, g-force level.
Optional audio recording.	AVI conversion tool. Data remains watermarked.
Connects directly to vehicle ignition power, automated operation.	Cloud upload feature. Easily share large HD videos that are too large to attach to email.
Tamper-resistant design, key required to access SD card data.	Google maps integration for route tracking.
GPS records full time to provide location data, vehicle speed, and accurate time/date.	Google earth export tool.
Adjustable resolution and frame rate.	Save/Print Event Reports.
Built-in G-shock sensor (adjustable sensitivity).	Free software and firmware updates.

2. SVC1080-LCS Overview

a. Front



b. Rear

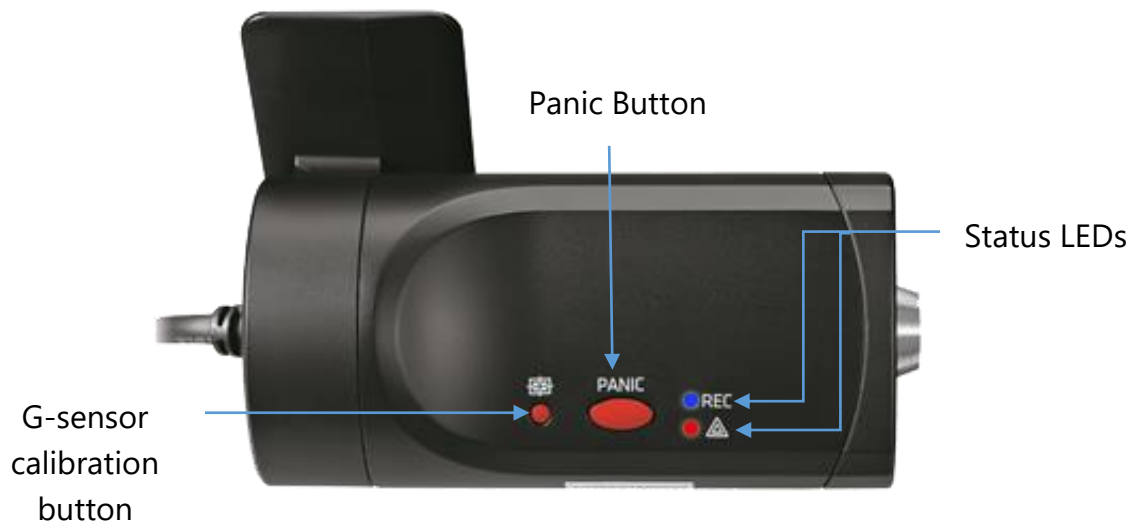

3. Installation Steps

1. Use the provided key to remove the locking cover.



2. After unlocking the cover, insert the SD card into the slot as shown. Make sure the Sd card is inserted all the way and "clicks" into place.

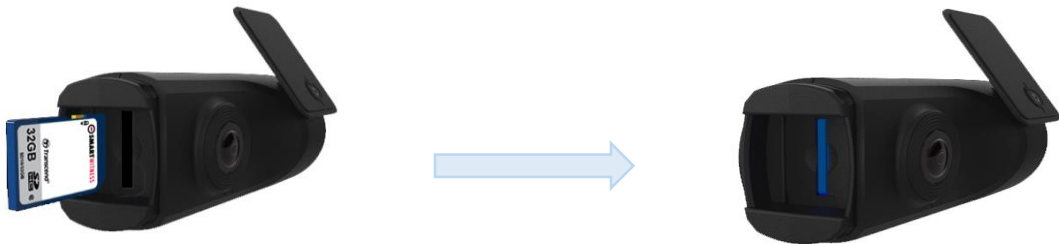

3. Adjust the bracket angle by pulling the bracket away from the camera body and rotating it to the desired angle (use the windshield as a guide to determine the angle (see the image at step #4). Push the bracket back into the body and secure it first with the bracket lock and then the bracket lock screw, as seen below

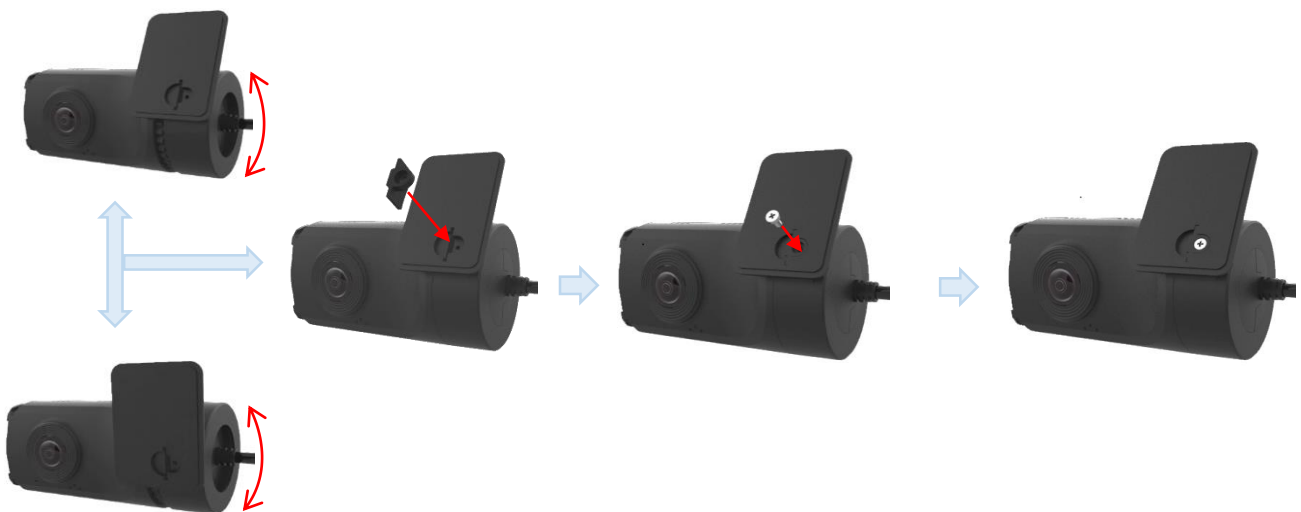



4. Attach the provided 3M adhesive pad to the SVC1080-LCS bracket and press firmly.
5. Secure the SVC1080-LCS to the windscreen behind the rear view mirror, below the A1 line. **The camera lens should be as high on the windshield as possible, but still within the windshield wiper zone.**

IMPORTANT: Make sure that the glass is clean and dry before attaching. Hold the camera in position with firm pressure for 30 seconds. The glass temperature should not be too hot or cold. Please install in moderate temperature (recommended between 50°F ~ 80°F)

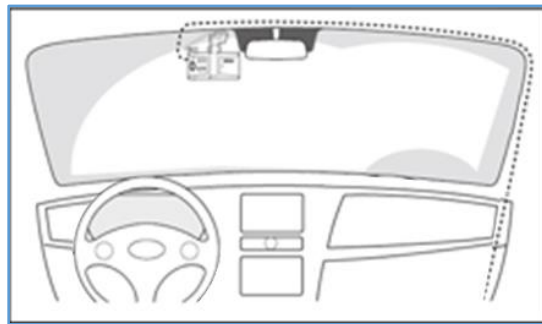

6. The below pictures demonstrate proper SVC1080-LCS installation on the windshield.

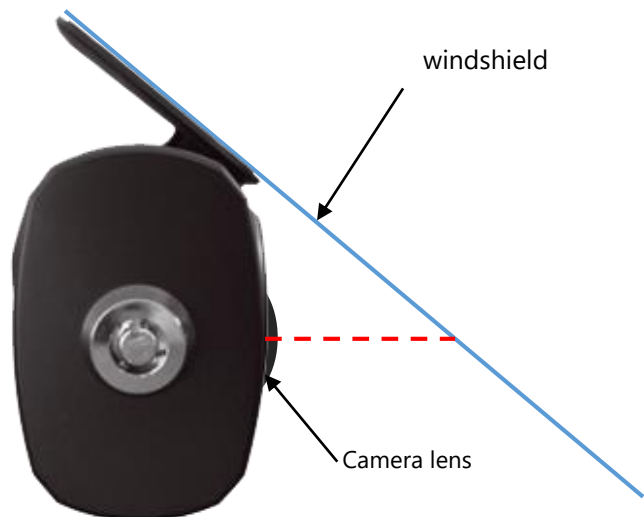

4. SVC1080-LCS Power Connection:

1. First, connect the power lead cable from the camera to the power extension by connecting the white molex connectors, as seen below.

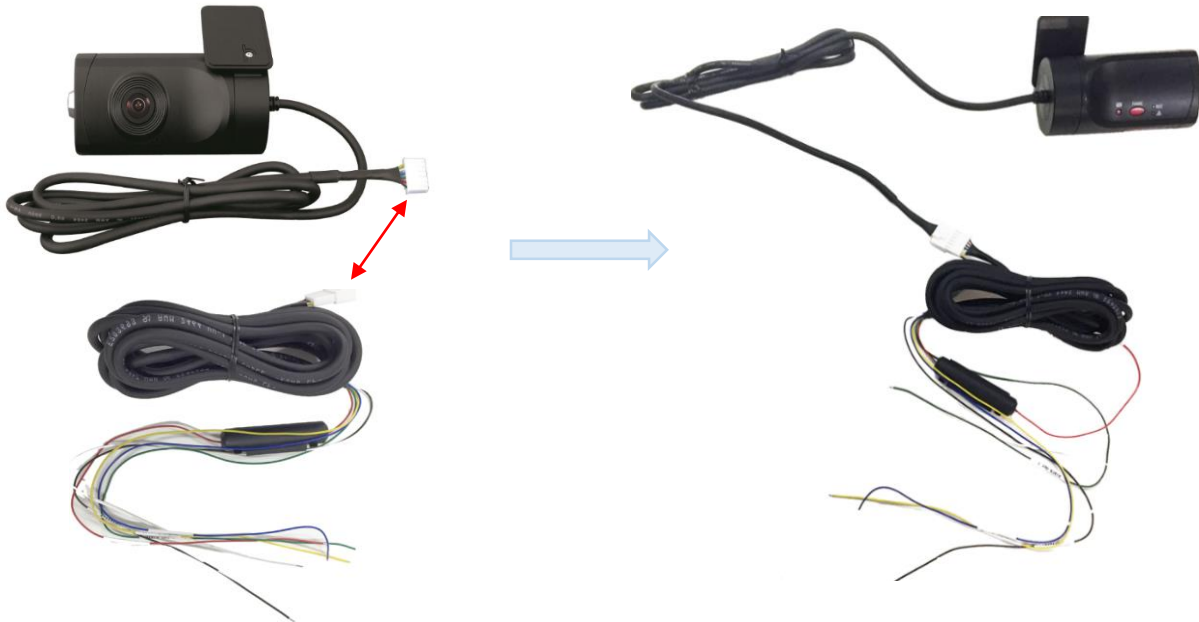

2. Wiring Diagram

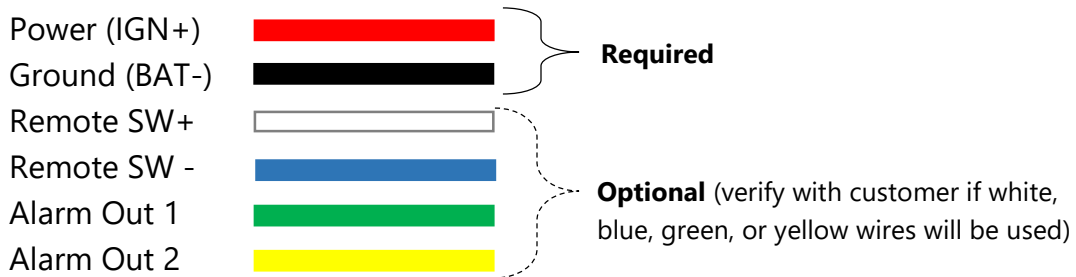

3. OPTIONAL remote switch installation (your SVC1080-LCS may not include this accessory)



Model # **SW-PB**

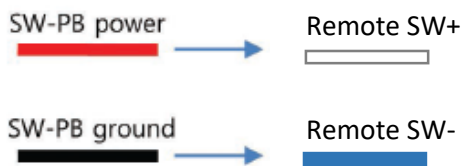



5. Final Steps

After installation of the SVC1080-LCS into the vehicle, you can turn on vehicle ignition and the camera will power on. There will be a sequence of BLUE/RED LED lights cycling during boot process. **Once boot up is complete. There will be a solid blue light. This means proper operation and recording. If a red led comes on after bootup, there is an error and you should contact your supplier or SmartWitness. Please refer to troubleshooting section for more detailed information the LED status indicators.**

- 1) After the camera has been booted completely, press the G-Sensor calibration button once (small red button to the left of the panic button).



There will be a beep and LED light blink to indicate the G-Sensor calibration has registered.

- 2) Press the Panic button once to ensure it's working properly. The Blue LED should flash rapidly to indicate event recording has begun.
- 3) Give the provided keyset to the fleet owner/manager/administrator as well as a copy of the installation report. If you do not have an installation report template, you can visit <http://install.smartwitness.com> and complete the installation form there.



Troubleshooting

- **The SVC1080-LCS does not power up (BLUE/RED LEDs do not turn on)**
 - Please check the power and ground connections to the vehicle.
 - Use a multimeter to ensure the camera is receiving proper voltage
 - If connecting to fuse panel, check the vehicle fuse
 - Check the in-line fuse located on the red power cable of the SVC1080-LCS
 - *If none of these work, please contact SmartWitness
- **The Blue LED is off and the Red light is blinking**
 - This is an SD card problem
 - Make sure the SD card is inserted properly into the camera (see step # 2 of Installation Steps)
 - Check to make sure the yellow switch on the SD card is in the UNLOCK position
 - If the above do not work, try another SD card. If the 2nd SD card works, then please contact SmartWitness to repair/replace the defective card.

6. LED Reference Table:

SVC1080-LCS Status	Blue	Red	Buzzer
Booting	On	On	Off
Upgrade	Heartbeat	Heartbeat	Off
Continuous recording	4sec On, 1sec Off (Continuously)	Off	Off
Event Pre recording	2sec On/Off (Continuously)	Off	Off
Triggered / event recording	500msec On/Off (Continuously)	Off	100msec On (1time)
SD card fault	Off	500msec On/Off (Continuously)	Off
System fault	On	On	Off
No SD Card	Off	500msec On/Off (Continuously)	5sec On (1time)
SD Full	Off	2sec On/Off (Continuously)	Off
Parking mode	8sec On, 1sec Off (Continuously)	Off	Off
Power off	Off	Off	Off

For complete user manual, training videos, and technical support inquiries, please visit support.smartwitness.com