

! IMPORTANT:

Read ALL instructions carefully before beginning installation.

BMW R 1200 R/RS 2014+ STORAGE POD INSTALLATION and OPERATION INSTRUCTIONS

NOTE: The Pod removes and installs exactly like the rear seat. No special tools are required. Lock and unlock using the stock key.

Preparation:

1. Remove rear seat.

Installation and removal:

1. Install the Pod Unit just as you would the stock seat, engaging the rear tabs and being sure to push down in the front to engage the latch. To remove, simply use the OEM key to unlock and remove.

Operation:

POD light and batteries:

Two CR2430-3V batteries included. To activate POD light, remove clear plastic tab between batteries. To replace batteries, remove two Phillips screws **1**, remove cover and circuit board **2** then remove and replace batteries **3**, negative side up. Reassemble components as listed above in reverse order.

IMPORTANT:

Storage POD light is tilt activated. For long term storage, remove batteries or store POD in a horizontal position.

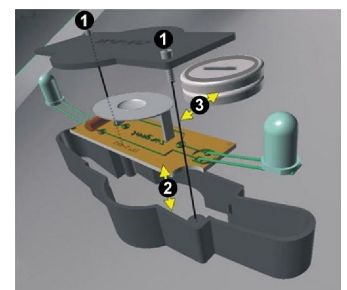

Storage POD Latch and Lock:



While standing at the rear of your motorcycle, slide the World Sport logo latch to the left to open your Storage POD. Locking the Storage POD will prevent the latch from opening the POD.