



FDV451

FREE STANDING **DIRECT VENT** GAS STOVE



THE ULTIMATE IN DESIGN, ENGINEERING & QUALITY

Unit illustrated is a FDV451N Free Standing Direct Vent Gas Stove - Natural Gas, F450FBL Door Front - Charcoal with Flat Black Posts, F451SDFBL Side Doors with Flat Black Frame and Charcoal Flame Panel, LOGF451 Oak Log Set, F451RLT Traditional Brick Liner, F45FK Fan Kit.



FDV451

FREE STANDING DIRECT VENT GAS STOVE

A SAFE AND EFFICIENT HEATING APPLIANCE WITH THE CONVENIENCE OF GAS

Model	FDV451N/NE	FDV451LP/LPE
Gas Control	Millivolt / IPI	Millivolt / IPI
Fuel	Natural	Propane
Input High	34,500 BTU	31,000 BTU
Input Low	23,750 BTU	24,500 BTU
FE (P.4.1-02)	70.53% / 73.53%	70.12% / 74.28%

Unit illustrated is a FDV451N Free Standing Direct Vent Gas Stove - Natural Gas, F450FPB Door Front - Charcoal with Powder Coated Black Posts, F451SDFPB Side Doors with Powder Coated Black Frame and Charcoal Flame Panel, Z5GC Bronze Glass (x3), F45LG Log Grate, F451PL Reflective Porcelain Liner, F45FK Fan Kit.



STANDARD FEATURES*

- Millivolt or IPI valve system allows operation during a power failure with Hi-Low heat and flame adjustment
- Dual burner system, with Realistic Flame Pattern
- Heat radiating ceramic glass
- Mobile home approved - (Direct Vent Model Only)
- Approved for installation in a bedroom or bed sitting room
- Safety Screen Barrier*



Safety Screen Barrier

OPTIONAL FEATURES

Fan Kit

Heat activated with variable speed control

Three Colour Options

Front Color Choices:

Charcoal with Accent colors of Flat Black, Powder Coated Black, or Stainless Steel

Side Panels - Flame Pattern or Solid Panel:

Charcoal Panels with Trim colors of Flat Black, Powder Coated Black, or Stainless Steel

Log Sets

Oak

Brick Refractory Liner

Traditional or Herringbone

Reflective Porcelain Liner

Media Types:

Bronze Glass or Cannonballs

Thermostat

Wall Mount Millivolt Thermostat or Programmable Thermostat

Remote Control

On/Off, Thermostat On/Off, Thermostat On/Off modulating, Thermostat On/Off modulating and fan control



* All gas fireplaces manufactured as of January 1, 2015 will include a Safety Screen Barrier



THE ULTIMATE IN DESIGN, ENGINEERING & QUALITY

The FDV451 Direct Vent Model provides sealed combustion where it draws outside air for combustion. This model can be vented either horizontally or vertically.

SIZING AND DIMENSIONS

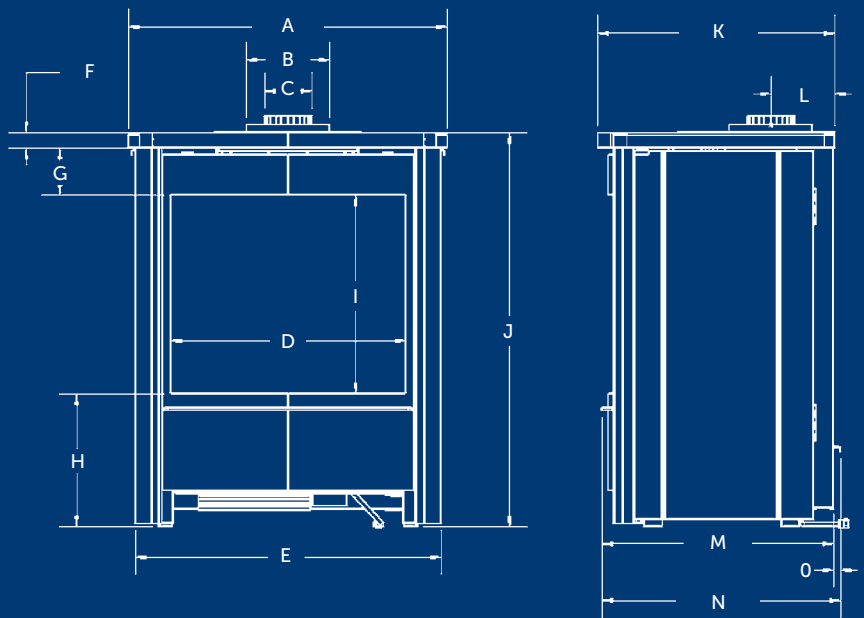

A	27 1/8"	I	16 15/16"
B	7"	J	33 1/2"
C	4"	K	20 1/8"
D	20"	L	5 3/8"
E	26"	M	19 3/4"
F	1 1/4"	N	20 5/16"
G	4"	O	9/16"
H	11 5/16"	P	20 5/8"

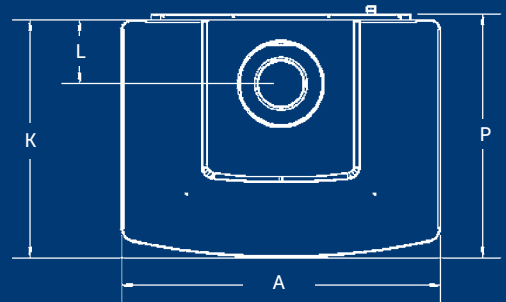

MINIMUM CLEARANCES TO COMBUSTIBLES:

36" from front of unit
 15 1/2" from side of unit
 2 1/2" from back of unit

ALCOVE INSTALLATION:

48" depth (max.)
 71 1/2" height (min.)
 58" width (min.)



Unit illustrated is a FDV451N Free Standing Direct Vent Gas Stove – Natural Gas, F450FBL Door Front – Charcoal with Black Posts, F451SDSBL Side Doors with Black Frame and Charcoal Solid Panel, Z5GC Bronze Glass (x3), RBCB1 Cannonballs, F45LG Log Grate, F45FK Fan Kit.



Powder Coated Vent Lid



Stainless Steel and Flat Black Vent Lid

STYLING

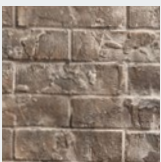

Traditional Brick Liner RLT

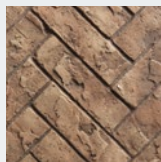

Herringbone Brick Liner RLH



2340 Logan Avenue
Winnipeg, Manitoba, Canada R2R 2V3
Phone: (204) 632-1962 Fax: (204) 632-1960
www.kingsmanfireplaces.com

FDV451

FREE STANDING **DIRECT VENT** GAS STOVE



*Components may have to be ordered separately to create a complete unit. Discuss with your local Kingsman dealer for clarification.
Kingsman Industries maintains a program of continuous testing, refinement and improvements of all its products. Some aspect of units shown here may be changed at any time without notice or obligation. Certified for Canada and USA: ANSI Z21.88-2014; CSA 2.33-2014 as a Vented Gas Fireplace Heater.